

HMR430

HY-MAX 래디우스 엔드밀 4날 헬릭스30°
HY-MAX Radius End Mill 4-Flute Helix30°

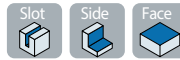
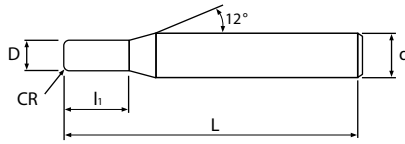

* 적용 피삭재 (Applicable Work Material)
◎ : 최적 (Most Suitable)
○ : 가능 (Applicable)

CARBIDE ULTRA
TiSiN
4
30° Helix
Multi Helix
CR ±0.005
CR ±0.01
D 0/-0.008
D 0/-0.015
Shank h5

D ≥ 2 R < 0.5 R ≥ 0.5 D < 6 D ≥ 6 h5

P			H			M	S	N		
탄소강 Carbon Steels	합금강 Alloy Steels	프리하든강 Pre-Hardened Steels	열처리강 Hardened Steels			스테인리스강 Stainless Steels	내열합금강 Heat-resistant alloys	동 Copper	알루미늄합금 Aluminum Alloys	흑연 Graphite
S45C/S50C ~800N/mm ²	SCM ~35HRC	NAK/HPM ~45HRC	SKD61 ~55HRC	SKD11 ~60HRC	SKH ~62HRC					
○	◎	◎	◎	◎	○	○	○			

단위(mm)/Unit(mm)

모델번호 Model No.	인선직경 Dia of Mill	코너반경 Coner Radius	날장 Length of Cut	전장 Overall Length	생크경 Shank Dia	비고 Remark
	D	CR	L ₁	L	d	
NEW HMR430-006R005-045-S04	0.6	0.05	1.2	45	4	
NEW HMR430-006R01-045-S04	0.6	0.1	1.2	45	4	
NEW HMR430-008R005-045-S04	0.8	0.05	1.6	45	4	
NEW HMR430-008R01-045-S04	0.8	0.1	1.6	45	4	
NEW HMR430-008R02-045-S04	0.8	0.2	1.6	45	4	
HMR430-010R005-045-S04	1	0.05	2.5	45	4	
HMR430-010R01-045-S04	1	0.1	2.5	45	4	
HMR430-010R02-045-S04	1	0.2	2.5	45	4	
HMR430-010R03-045-S04	1	0.3	2.5	45	4	
HMR430-015R01-045-S04	1.5	0.1	4	45	4	
HMR430-015R02-045-S04	1.5	0.2	4	45	4	
HMR430-015R03-045-S04	1.5	0.3	4	45	4	
HMR430-015R05-045-S04	1.5	0.5	4	45	4	
HMR430-020R01-045-S04	2	0.1	6	45	4	
HMR430-020R02-045-S04	2	0.2	6	45	4	
HMR430-020R03-045-S04	2	0.3	6	45	4	
HMR430-020R05-045-S04	2	0.5	6	45	4	
HMR430-025R01-045-S04	2.5	0.1	7	45	4	
HMR430-025R02-045-S04	2.5	0.2	7	45	4	
HMR430-025R03-045-S04	2.5	0.3	7	45	4	
HMR430-025R05-045-S04	2.5	0.5	7	45	4	
NEW HMR430-030R01-050-S03	3	0.1	8	50	3	
HMR430-030R01-060-S06	3	0.1	8	60	6	
NEW HMR430-030R02-050-S03	3	0.2	8	50	3	
HMR430-030R02-060-S06	3	0.2	8	60	6	
NEW HMR430-030R03-050-S03	3	0.3	8	50	3	
HMR430-030R03-060-S06	3	0.3	8	60	6	
NEW HMR430-030R05-050-S03	3	0.5	8	50	3	

HMR430

모델번호 Model No.	인선직경 Dia of Mill	코너반경 Coner Radius	날장 Length of Cut	전장 Overall Length	생크경 Shank Dia	비고 Remark
	D	CR	L ₁	L	d	
HMR430-030R05-060-S06	3	0.5	8	60	6	
NEW HMR430-030R10-050-S03	3	1	8	50	3	
HMR430-030R10-060-S06	3	1	8	60	6	
NEW HMR430-040R01-050-S04	4	0.1	10	50	4	
HMR430-040R01-080-S04	4	0.1	10	80	4	
HMR430-040R01-050-S06	4	0.1	10	50	6	
HMR430-040R01-070-S06	4	0.1	10	70	6	
NEW HMR430-040R02-050-S04	4	0.2	10	50	4	
HMR430-040R02-080-S04	4	0.2	10	80	4	
HMR430-040R02-050-S06	4	0.2	10	50	6	
HMR430-040R02-070-S06	4	0.2	10	70	6	
NEW HMR430-040R03-050-S04	4	0.3	10	50	4	
HMR430-040R03-080-S04	4	0.3	10	80	4	
HMR430-040R03-050-S06	4	0.3	10	50	6	
HMR430-040R03-070-S06	4	0.3	10	70	6	
NEW HMR430-040R05-050-S04	4	0.5	10	50	4	
HMR430-040R05-080-S04	4	0.5	10	80	4	
HMR430-040R05-050-S06	4	0.5	10	50	6	
HMR430-040R05-070-S06	4	0.5	10	70	6	
NEW HMR430-040R10-050-S04	4	1	10	50	4	
HMR430-040R10-080-S04	4	1	10	80	4	
HMR430-040R10-050-S06	4	1	10	50	6	
HMR430-040R10-070-S06	4	1	10	70	6	
HMR430-050R02-070-S06	5	0.2	10	70	6	
HMR430-050R03-070-S06	5	0.3	10	70	6	
HMR430-050R05-070-S06	5	0.5	10	70	6	
HMR430-050R10-070-S06	5	1	10	70	6	
HMR430-060R02-060-S06	6	0.2	12	60	6	
NEW HMR430-060R02-075-S06	6	0.2	12	75	6	
HMR430-060R02-090-S06	6	0.2	12	90	6	
HMR430-060R03-060-S06	6	0.3	12	60	6	
NEW HMR430-060R03-075-S06	6	0.3	12	75	6	
HMR430-060R03-090-S06	6	0.3	12	90	6	
HMR430-060R05-060-S06	6	0.5	12	60	6	
NEW HMR430-060R05-075-S06	6	0.5	12	75	6	
HMR430-060R05-090-S06	6	0.5	12	90	6	
HMR430-060R10-060-S06	6	1	12	60	6	
NEW HMR430-060R10-075-S06	6	1	12	75	6	
HMR430-060R10-090-S06	6	1	12	90	6	
NEW HMR430-060R15-060-S06	6	1.5	12	60	6	
NEW HMR430-060R15-075-S06	6	1.5	12	75	6	
NEW HMR430-060R15-090-S06	6	1.5	12	90	6	
HMR430-080R02-060-S08	8	0.2	16	60	8	
NEW HMR430-080R02-075-S08	8	0.2	16	75	8	
HMR430-080R02-090-S08	8	0.2	16	90	8	
HMR430-080R03-060-S08	8	0.3	16	60	8	
NEW HMR430-080R03-075-S08	8	0.3	16	75	8	
HMR430-080R03-090-S08	8	0.3	16	90	8	
HMR430-080R05-060-S08	8	0.5	16	60	8	

HMR430

블 Ball	모델번호 Model No.	인선직경	코너반경	날장	전장	생크경	비고 Remark
		Dia of Mill	Coner Radius	Length of Cut	Overall Length	Shank Dia	
라디우스 Radius	HMR430-080R05-075-S08	8	0.5	16	75	8	
스퀘어 Square	HMR430-080R05-090-S08	8	0.5	16	90	8	
	HMR430-080R10-060-S08	8	1	16	60	8	
	HMR430-080R10-075-S08	8	1	16	75	8	
	HMR430-080R10-090-S08	8	1	16	90	8	
	HMR430-080R20-060-S08	8	2	16	60	8	
	HMR430-080R20-075-S08	8	2	16	75	8	
	HMR430-080R20-090-S08	8	2	16	90	8	
	HMR430-100R02-070-S10	10	0.2	20	70	10	
	HMR430-100R02-100-S10	10	0.2	20	100	10	
	HMR430-100R02-130-S10	10	0.2	20	130	10	
	HMR430-100R03-070-S10	10	0.3	20	70	10	
	HMR430-100R03-100-S10	10	0.3	20	100	10	
	HMR430-100R03-130-S10	10	0.3	20	130	10	
	HMR430-100R05-070-S10	10	0.5	20	70	10	
	HMR430-100R05-100-S10	10	0.5	20	100	10	
	HMR430-100R05-130-S10	10	0.5	20	130	10	
	HMR430-100R10-070-S10	10	1	20	70	10	
	HMR430-100R10-100-S10	10	1	20	100	10	
	HMR430-100R10-130-S10	10	1	20	130	10	
	HMR430-100R20-070-S10	10	2	20	70	10	
	HMR430-100R20-100-S10	10	2	20	100	10	
	HMR430-100R20-130-S10	10	2	20	130	10	
	HMR430-120R02-080-S12	12	0.2	24	80	12	
	HMR430-120R02-100-S12	12	0.2	24	100	12	
	HMR430-120R02-130-S12	12	0.2	24	130	12	
	HMR430-120R05-080-S12	12	0.5	24	80	12	
	HMR430-120R05-100-S12	12	0.5	24	100	12	
	HMR430-120R05-110-S12	12	0.5	24	110	12	
	HMR430-120R05-130-S12	12	0.5	24	130	12	
	HMR430-120R10-080-S12	12	1	24	80	12	
	HMR430-120R10-100-S12	12	1	24	100	12	
	HMR430-120R10-110-S12	12	1	24	110	12	
	HMR430-120R10-130-S12	12	1	24	130	12	
	HMR430-120R20-080-S12	12	2	24	80	12	
	HMR430-120R20-100-S12	12	2	24	100	12	
	HMR430-120R20-130-S12	12	2	24	130	12	

HMRE230

HY-MAX 리브 스퀘어 엔드밀 2날 헬릭스30°

HY-MAX Rib Square End Mill 2-Flute Helix30°

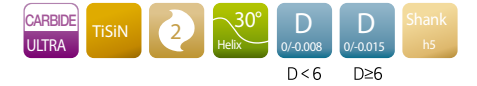
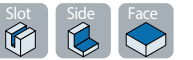
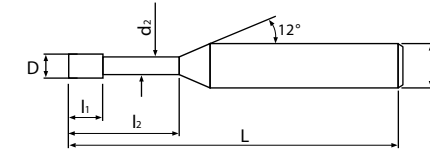

* 적용 피삭재 (Applicable Work Material)
 ◎ : 최적 (Most Suitable)
 ○ : 가능 (Applicable)

P			H			M	S	N		
탄소강 Carbon Steels	합금강 Alloy Steels	프리하든강 Pre-Hardened Steels	열처리강 Hardened Steels			스테인리스강 Stainless Steels	내열합금강 Heat-resistant alloys	동 Copper	알루미늄합금 Aluminum Alloys	흑연 Graphite
S45C/S50C ~800N/mm ²	SCM ~35HRC	NAK/HPM ~45HRC	SKD61 ~55HRC	SKD11 ~60HRC	SKH ~62HRC					
○	◎	◎	○			○	○	○		

단위(mm)/Unit(mm)

모델번호 Model No.	인선직경	유효장	날장	목부경	전장	생크경	비고 Remark
	Dia of Mill	Effective Length	Length of Cut	Neck Dia	Overall Length	Shank Dia	
HMRE230-001005-045-S04	0.1	0.5	0.1	0.085	45	4	
HMRE230-0015005-045-S04	0.15	0.5	0.15	0.13	45	4	
HMRE230-001501-045-S04	0.15	1	0.15	0.13	45	4	
HMRE230-002005-045-S04	0.2	0.5	0.2	0.18	45	4	
HMRE230-00201-045-S04	0.2	1	0.2	0.18	45	4	
HMRE230-002015-045-S04	0.2	1.5	0.2	0.18	45	4	
HMRE230-00202-045-S04	0.2	2	0.2	0.18	45	4	
HMRE230-00301-045-S04	0.3	1	0.3	0.27	45	4	
HMRE230-003015-045-S04	0.3	1.5	0.3	0.27	45	4	
HMRE230-00302-045-S04	0.3	2	0.3	0.27	45	4	
HMRE230-00303-045-S04	0.3	3	0.3	0.27	45	4	
HMRE230-00401-045-S04	0.4	1	0.4	0.37	45	4	
HMRE230-00402-045-S04	0.4	2	0.4	0.37	45	4	
HMRE230-00403-045-S04	0.4	3	0.4	0.37	45	4	
HMRE230-00404-045-S04	0.4	4	0.4	0.37	45	4	
HMRE230-00405-045-S04	0.4	5	0.4	0.37	45	4	
HMRE230-00406-045-S04	0.4	6	0.4	0.37	45	4	
HMRE230-00502-045-S04	0.5	2	0.5	0.46	45	4	
HMRE230-00503-045-S04	0.5	3	0.5	0.46	45	4	
HMRE230-00504-045-S04	0.5	4	0.5	0.46	45	4	
HMRE230-00505-045-S04	0.5	5	0.5	0.46	45	4	
HMRE230-00506-045-S04	0.5	6	0.5	0.46	45	4	
HMRE230-00508-045-S04	0.5	8	0.5	0.46	45	4	
HMRE230-00510-045-S04	0.5	10	0.5	0.46	45	4	
HMRE230-00602-045-S04	0.6	2	0.6	0.56	45	4	
HMRE230-00603-045-S04	0.6	3	0.6	0.56	45	4	
HMRE230-00604-045-S04	0.6	4	0.6	0.56	45	4	