

DMRE230

DIA-MAX 리브스퀘어엔드밀2날 헬릭스30°

DIA-MAX Rib Square End Mill 2-Flute Helix30°

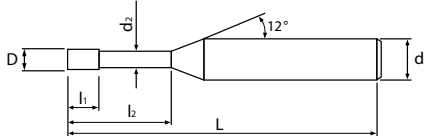

* 적용피삭재(Applicable Work Material)

: 최적(Most Suitable)

: 가능(Applicable)

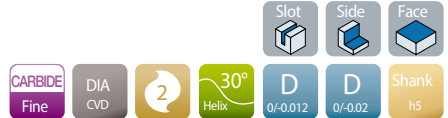

D<1

D≥1

| P | | | H | | | M | S | N | | |
|-------------------------------------|---------------------|------------------------------|-------------------------|-----------------|---------------|----------------------------|--------------------------------|-------------|---------------------------|----------------|
| 탄소강 Carbon Steels | 합금강 Alloy Steels | 프리하든강 Pre-Hardened Steels | 열처리강 Hardened Steels | | | 스테인레스강 Stainless Steels | 내열합금강 Heat-resistant alloys | 동 Copper | 알루미늄합금 Aluminum Alloys | 흑연 Graphite |
| S45C/S50C ~800 N/mm ² | SCM ~35HRC | NAK/HPM ~45HRC | SKD61 ~55HRC | SKD11 ~60HRC | SKH ~62HRC | | | | | |

단위(mm)/Unit(mm)

| 모델번호 Model No. | 인선직경 Dia of Mill | 유효장 Effective Length | 날장 Length of Cut | 목부경 Neck Dia | 전장 Overall Length | 생크경 Shank Dia | 비고 Remark |
|------------------------|---------------------|-------------------------|---------------------|-----------------|----------------------|------------------|--------------|
| | D | l ₂ | l ₁ | d ₂ | L | d | |
| DMRE230-00201-045-S04 | 0.2 | 1 | 0.2 | 0.17 | 45 | 4 | |
| DMRE230-002015-045-S04 | 0.2 | 1.5 | 0.2 | 0.17 | 45 | 4 | |
| DMRE230-003015-045-S04 | 0.3 | 1.5 | 0.3 | 0.25 | 45 | 4 | |
| DMRE230-00302-045-S04 | 0.3 | 2 | 0.3 | 0.25 | 45 | 4 | |
| DMRE230-00303-045-S04 | 0.3 | 3 | 0.3 | 0.25 | 45 | 4 | |
| DMRE230-00402-045-S04 | 0.4 | 2 | 0.4 | 0.35 | 45 | 4 | |
| DMRE230-00403-045-S04 | 0.4 | 3 | 0.4 | 0.35 | 45 | 4 | |
| DMRE230-00404-045-S04 | 0.4 | 4 | 0.4 | 0.35 | 45 | 4 | |
| DMRE230-00502-045-S04 | 0.5 | 2 | 1 | 0.45 | 45 | 4 | |
| DMRE230-00504-045-S04 | 0.5 | 4 | 1 | 0.45 | 45 | 4 | |
| DMRE230-00506-045-S04 | 0.5 | 6 | 1 | 0.45 | 45 | 4 | |
| DMRE230-00602-045-S04 | 0.6 | 2 | 1.2 | 0.55 | 45 | 4 | |
| DMRE230-00604-045-S04 | 0.6 | 4 | 1.2 | 0.55 | 45 | 4 | |
| DMRE230-00606-045-S04 | 0.6 | 6 | 1.2 | 0.55 | 45 | 4 | |
| DMRE230-00804-045-S04 | 0.8 | 4 | 1.6 | 0.75 | 45 | 4 | |
| DMRE230-00806-045-S04 | 0.8 | 6 | 1.6 | 0.75 | 45 | 4 | |
| DMRE230-00808-045-S04 | 0.8 | 8 | 1.6 | 0.75 | 45 | 4 | |
| DMRE230-01004-050-S04 | 1 | 4 | 2 | 0.95 | 50 | 4 | |
| DMRE230-01006-050-S04 | 1 | 6 | 2 | 0.95 | 50 | 4 | |
| DMRE230-01008-050-S04 | 1 | 8 | 2 | 0.95 | 50 | 4 | |
| DMRE230-01010-050-S04 | 1 | 10 | 2 | 0.95 | 50 | 4 | |
| DMRE230-01012-050-S04 | 1 | 12 | 2 | 0.95 | 50 | 4 | |
| DMRE230-01016-050-S04 | 1 | 16 | 2 | 0.95 | 50 | 4 | |
| DMRE230-01506-050-S04 | 1.5 | 6 | 3 | 1.45 | 50 | 4 | |
| DMRE230-01508-050-S04 | 1.5 | 8 | 3 | 1.45 | 50 | 4 | |
| DMRE230-01510-050-S04 | 1.5 | 10 | 3 | 1.45 | 50 | 4 | |
| DMRE230-01512-050-S04 | 1.5 | 12 | 3 | 1.45 | 50 | 4 | |

DIA-MAX

볼
Ball

라디우스
Radius

스퀘어
Square